

IBM T.J. Watson

- Details about site: <https://research.ibm.com/labs/yorktown-heights>
- Visitor Information: https://research-website-prod-cms-uploads.s3.us.cloud-object-storage.appdomain.cloud/Yorktown_Visitor_Information_3d442309e5.pdf
- Directions:
https://www.google.com/maps/place/IBM+Thomas+J.+Watson+Research+Center/@41.2097516,-73.8052216,17z/data=!3m1!4b1!4m6!3m5!1s0x89c2b84f4fe21b2f:0x457b245b452ccf23!8m2!3d41.2097516!4d-73.8026467!16zL20vMDR6a3Q1?entry=ttu&g_ep=EgoyMDI0MDkyOS4wIjKXMDS0ASAFQAw%3D%3D

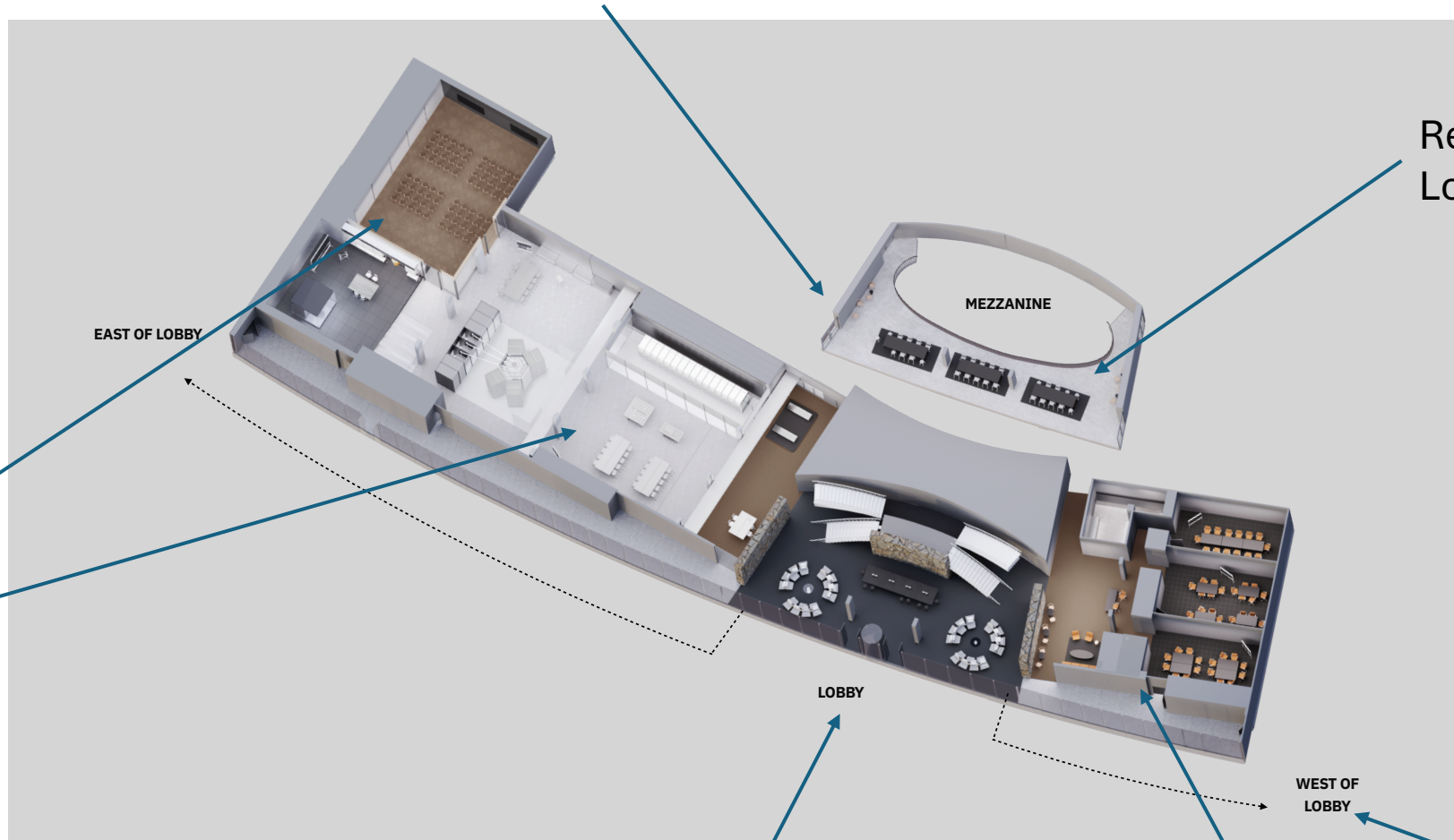

Refreshments/Breaks
Lobby, second floor

EAST OF LOBBY

MEZZANINE

LOBBY

WEST OF
LOBBY

Day 3 – Viz Theatre

Think Lab

The lobby is where
registration will be done.

Day 2 – Area B

Day 1&2 – Aisle 26
is in this direction
near the Cafeteria

Bathrooms are under the stairs in the lobby and down the hall at
the thinklab, Day 2, and Day 3.

Building Layout

Several helpful hints about the building.

- The building is circular, each room is on a spoke. The decoding for room numbers is (Aisle)-(Floor) (Room Number) e.g. my office is 1-203 meaning aisle 1, floor 2, room 3.
- Stairs and bathrooms are at every clock in the front of the building (facing North)
- Many areas are badged and will require an escort.

For days 1 & 2 we will be using Aisle 26 Floor 0 room as mapped out in the schedule.



Day 1

Day 1	Thursday October 17																						
	UTC-4																						
	900	930	1000	1030	1100	1130	1200	1230	1300	1330	1400	1430	1500	1530	1600	1630	1700	1730	1800	1830	1900		
Kickoff																							
Session 1																							
Session 2																							
Session 3																							
Break																							
Keynote 1																							
Keynote 2																							
Lunch																							
Session 4																							
Session 5																							
Session 6																							
Break																							
session 7																							
session 8																							
Session 9																							
Dinner																							
All (order 55?)					Aisle 26																		
Breaks					Mezzanine																		
Room 1					Aisle 26 A																		
Room 2					Aisle 26 B																		
Room 3					Aisle 26 C																		
Aisle 26 room. This will have to be broken down into separate rooms for the sub events and then recombined during breaks. We can also serve lunch there.																							

The Aisle 26 space is a 3 room space that will be used for lunch and common events, then pull out the walls for the breakout sessions.

Day 2

Day 2	Friday October 18																				
	UTC-4																				
	900	930	1000	1030	1100	1130	1200	1230	1300	1330	1400	1430	1500	1530	1600	1630	1700	1730	1800	1830	1900
Session 10																					
Session 11																					
Session 12																					
Break																					
Keynote 3																					
Keynote 4																					
Lunch																					
Session 13																					
Session 14																					
Session 15																					
Break																					
session 16																					
session 17																					
Session 18																					

All (order 55?)		Aisle 26 use full space
Breaks		Mezzanine
Lunch		Aisle 26 use full space
Room 1		Aisle 26 use full space
Room 2		Area B, room 1
Room 3		AreaB, room 2

Aisle 26 will be used for all person events, including lunch, and breakout session 1

Area B will be used for breakouts 2 & 3

Day 3

Day 3	Saturday October 19																				
	UTC-4																				
	900	930	1000	1030	1100	1130	1200	1230	1300	1330	1400	1430	1500	1530	1600	1630	1700	1730	1800	1830	1900
Session 19																					
Session 20																					
Session 21																					
Break																					
Keynote 5																					
Keynote 6																					
Lunch																					
Session 22																					
Session 23																					
WORKSHOP																					
Break																					
Closeout																					

All (order 55?)		Viz Theatre
Breaks		Mezzanine
Lunch		Viz Theatre
Room 1		Viz Theatre
Room 2		Area B, Room 1
Room 3		Area B, Room 2